

# TILT-UP CONSTRUCTION



CONSTRUCTION SUPPLIES

# Just One Call to A.H. Harris:

- For **all the construction materials** you need for your Tilt-Up Project.
- To contact any of the **40-plus Harris distribution centers** conveniently located throughout New England, New York, New Jersey, Maryland, North Carolina and Virginia.
- For **onsite assistance** and **superior technical expertise**.

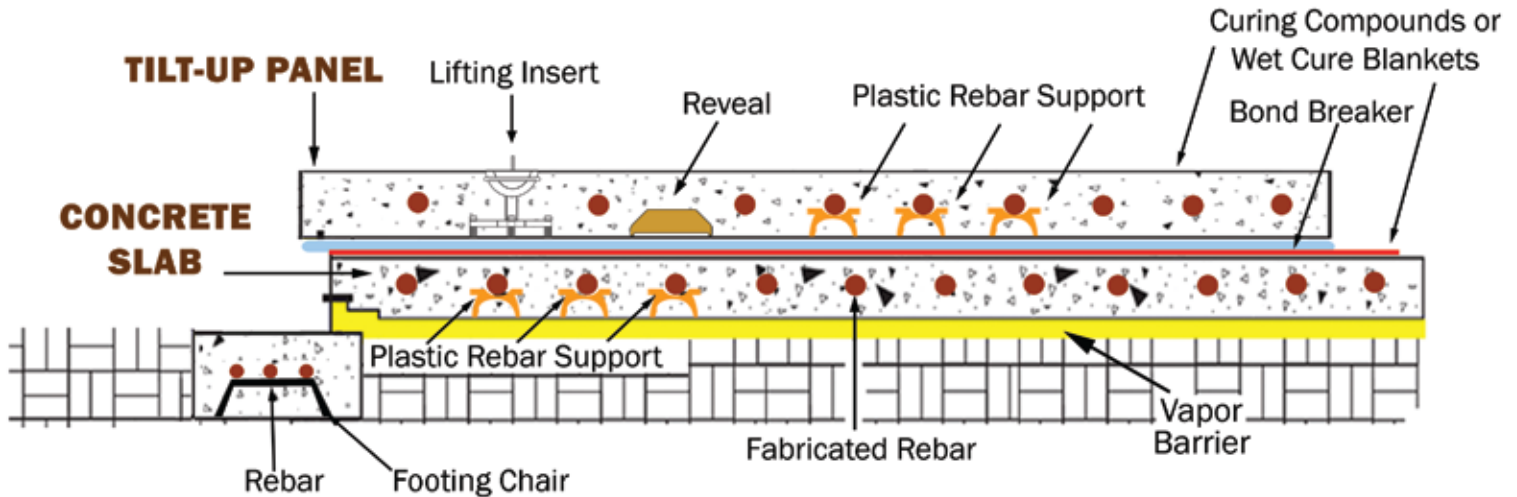

## REINFORCED TILT-UP PANEL

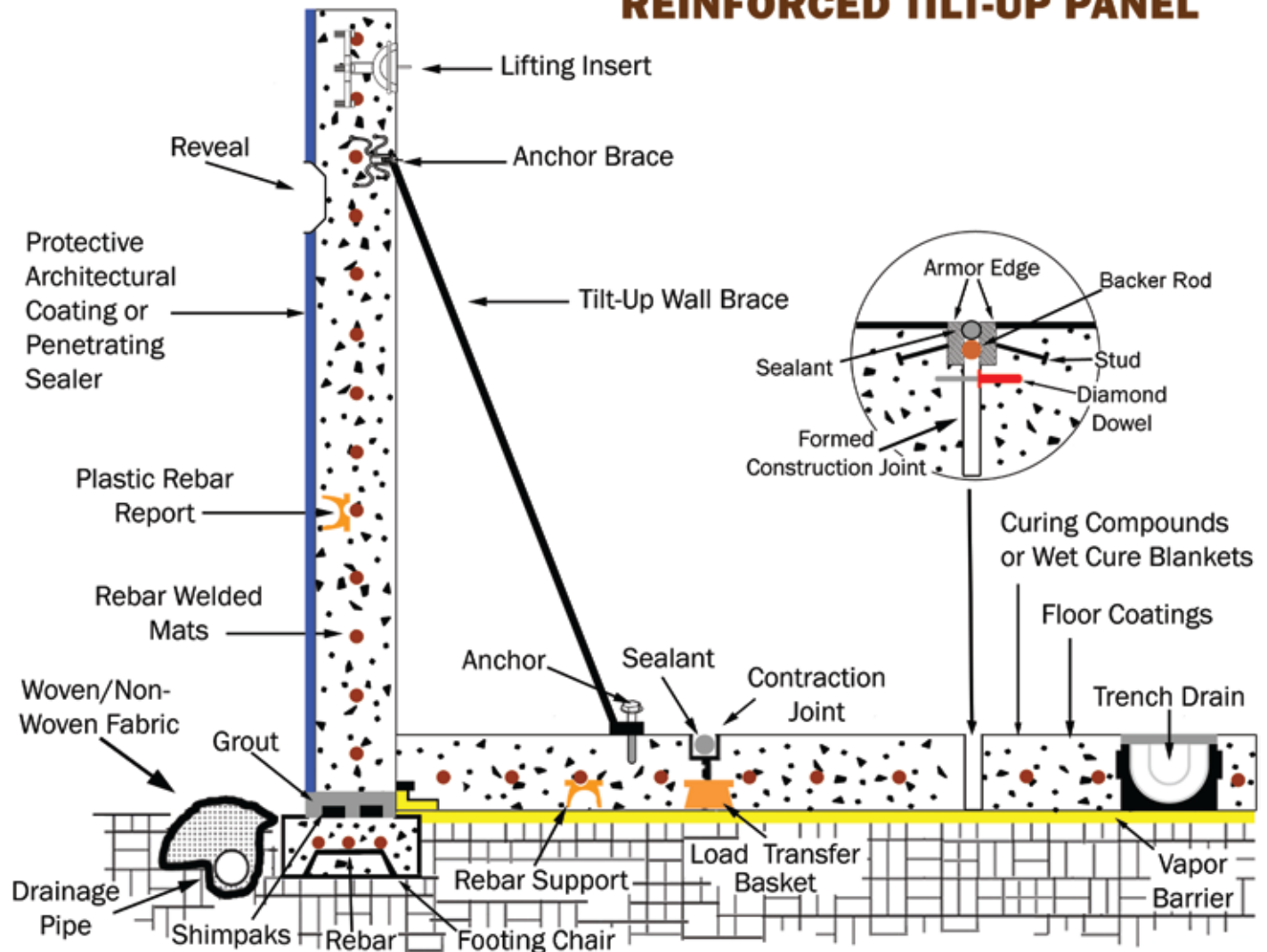

**The Biggest Advantages of Tilt-Up:**

- Fastest Form of Construction from Conception to Completion
- Most Versatile form of Construction – anything you can form you can pour
- Advancements in Technology have allowed tilt-up to grow – thin brick – brace badgers
- Can be poured through the winter months
- Green/Sustainable

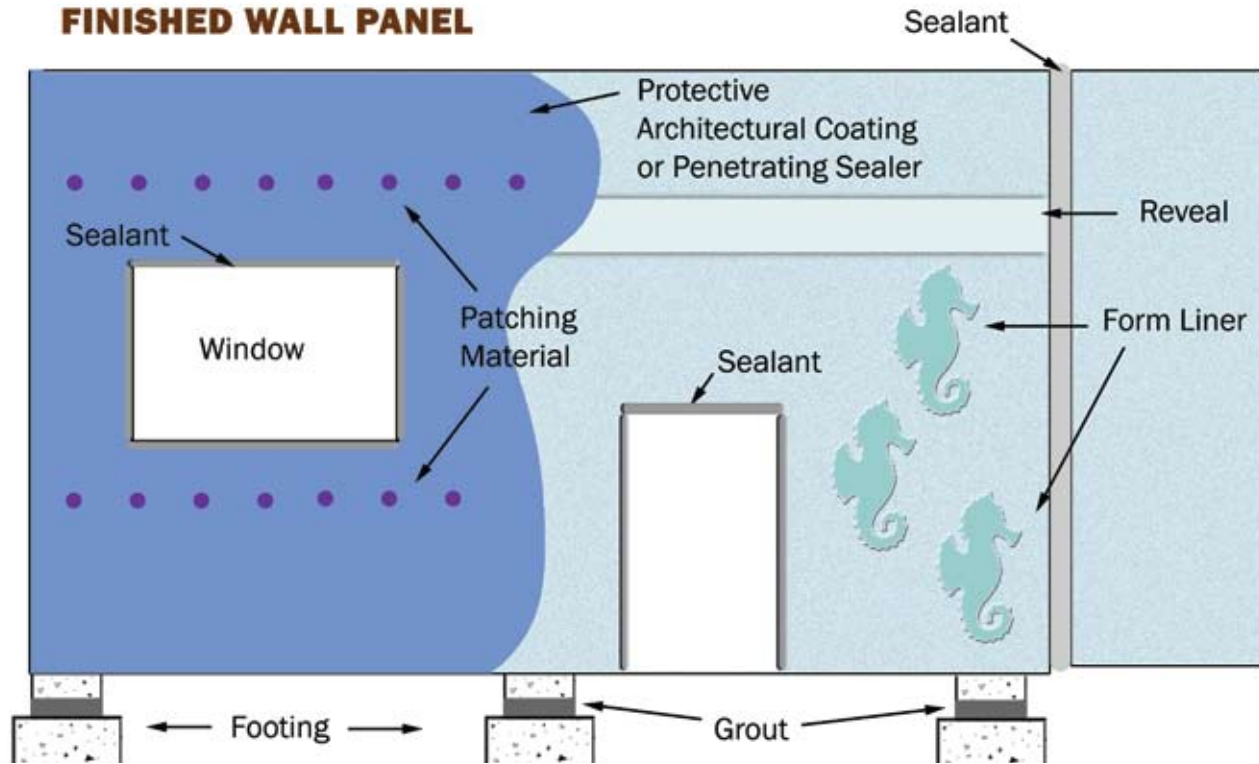

**TILT-UP PRODUCTS**

- Bond Breaker
- Concrete Cure
- Lifting Systems
- Bracing
- Coil Inserts
- Chamfer
- Keyway
- Tilt Bracket
- Form Angle/Brackets
- T-Strip
- Spray Adhesive
- Shim Strips
- Shimpaks
- Form Liners
- Thin Brick
- Key Joints
- Stakes
- Slab Bolster
- Chairs
- Reveal



**Any time you can pour concrete – you can utilize tilt-up construction. Weather conditions do not restrict or prohibit the tilt-up methodology!**



*Fastest form of construction from conception to completion.*



Integrally insulated sandwich panels allow tilt-up to take advantage of the Mass affect of concrete (the concrete's ability to absorb and store energy) resulting in an energy efficient wall system (GREEN/ SUSTAINABLE DESIGN) and often allowing for the reduction in HVAC.



Size is no longer a factor for tilt-up construction – from the largest distribution centers to additions/expansions to small offices.



A large site is no longer a requirement for tilt-up; rip slabs, pour slabs and stack casting are all viable options for panel construction. Rip Slabs (unreinforced concrete slab – typically 2-3" thick) can be used to cast panels and then "ripped" up and used for fill or paved over.



*Anything you can form - you can pour.*



*Thin brick allows tilt-up to "adapt" to existing structures.*



*Fastest form of construction from conception to completion.*



*Advancements in bracing technology allows for bracing to the interior or exterior of the building.*

**DIVISION 1 -  
GENERAL REQUIREMENTS**

Concrete Placing & Finishing Tools  
Hand & Power Tools  
Personal Protection & Safety  
Concrete Curing & Testing  
Equipment  
Marking Tools & Supplies  
Sprayers

**DIVISION 31 - EARTHWORK  
(Formerly Division 2 Sitework)**

Woven & Nonwoven Geotextiles  
Silt Fence

Erosion Control Blankets & Mats

Gabions

•Paving and Surfacing

Porous Pavements

Joint Sealing Compounds

Paving Fabrics

Low Modulus Horizontal Sealant

Rubber Asphalt Sealer

Pavement Reinforcement Mesh

Silicone Joint Sealant

•Sewerage & Drainage

Precast & Fiberglass Trench Drains

Turbidity Curtains

Pond Liners

•Site Improvements

Visual Barrier Fence

Safety Fence

Spill Containment Kits

**DIVISION 3 - CONCRETE**

•Concrete Forming

Symons Forming Systems

-Steel-Ply

-Resi-Ply

-Western Forms (Aluminum)

-Flex-Form

-Max-A-Form

-VersiForm

-DeckFast

Stay-Form

Aluminum Joist Gang

Box Culvert Travellers

Formright Saf Load

Aluminum Beam & Joists

Architectural Form Liners

Concrete Stamping

SONOCO - Sonotubes

**Division 3 continued**

Adjustable Bridge Deck Systems

Bridge Overhang Brackets

Insulated Concrete Forms

Adjustable Joist Hangers

Slab Accessories

Hanging Systems

Snap Ties

Heavy Duty Tie Systems

Reinforcing Bar Supports

Tilt up Accessories

Column Forms

Forming Coatings & Releases

Plywood

•Concrete Reinforcement

Rebar and Wire Mesh

Dowel Bar Sub

Taper Lock

•Concrete Accessories

Anchor Bolts

Expansion Joint Cap

Form A Key

Expansion Joint Filler

Nails

Control Joint

Waterstop

•Concrete Curing

Curing Compound, Hardeners

Sealers (V.O.C.)

Polyethylene Sheeting

Curing Paper

Curing Blankets

•Concrete Restoration & Cleaning

Protective Coatings & Sealers

Structural Repair Systems

Waterproofing

Epoxy Resins

Corrosion Inhibitors

Expanding Chemical Grouts

Modified Methacrylates

•Patching & Repair Mortars

Polymer Modified Cements

Machine Applied Mortars

Rapid Setting Mortars

Hydraulic Cement

•Grouts

Harris Construction Grout

Metallic and Nonmetallic

Non-shrink

High Flow

Precision

**Division 3 continued**

•Portland Cement

•Bonding & Epoxy Systems

Concrete & Epoxy Anchoring Capsules

Latex Bonding Agents

Epoxy Bonding Agents

Epoxy Injection Adhesive

Epoxy Mortar

Epoxy Control Joints

•Floor Toppings and Underlayment

Self Leveling-Cementitious

Polymer Modified Toppings

Heavy Duty Industrial Floor Toppings

**DIVISION 4 - MASONRY**

Masonry Wall Reinforcement

Flashing & Reglet

Rapid Control Joint

Dovetail Anchor Slot & Ties

Anchors - Epoxy & Mechanical

Masonry Restoration & Cleaning

**DIVISION 7 -**

**THERMAL & MOISTURE PROTECTION**

Waterproofing membranes

Bentonite Liners & Panels

Water Repellents

Insulation

Subsurface Drainage Matting

Polymer-Modified Protective Coatings

Dampproofing

Elastomeric Deck Coatings

Epoxies

Flashing

Joint Sealers

Backer Rod

Polyurethane Sealants

Polyurea Sealants & Coatings

**DIVISION 8 -**

**DOORS & WINDOWS**

Foundation Windows & Vents-

-Wood

-Steel

-Composite

-Vinyl

Flood Vents

Egress Window Wells

Egress Windows



**Connecticut**

Danbury (203)791-9308  
Newington (860)665-9400  
Stamford (203)978-9055  
Waterford (860)437-7815

**Maine**

Augusta (207)622-0821  
Bangor (207)262-6276  
Fryeburg (207)935-3531  
Portland (207)775-5764

**Maryland**

Baltimore (410)525-0480

**Massachusetts**

Boston (617)269-4800  
Buzzards Bay (508)759-9990  
Chicopee (413)535-0248  
Medfield (508)359-7321  
Raynham (508)884-5070  
Woburn (781)376-9636  
Worcester (508)767-0200

**New Hampshire**

Manchester (603)644-4970  
Portsmouth (603)436-3833  
West Lebanon (603)298-6072

**New Jersey**

Fairfield (973)227-1600  
Parlin (732)651-0970  
Pleasantville (609)677-6050  
Sayreville (732)651-7822

**New York**

Albany (518)438-3976  
Brooklyn (718)254-8000  
Buffalo (716)686-9123  
Massena (315)764-0241  
Newburgh (845)566-4040  
Plattsburgh (518)561-2525  
Rochester (585)426-2090  
Staten Island (718)876-7500

Syracuse (315)452-1080  
Yonkers (914)964-0101

**North Carolina**

Charlotte (704)921-4420

**Rhode Island**

Cranston (401)461-8020

**Vermont**

Williston (802)863-3302

**Virginia**

Bristol (276)642-0451  
Charlottesville (434)979-9902  
Hampton (757)838-5745  
Richmond (804)358-7191  
Salem (800)468-0155